



ARCHITECTURAL HARDWARE FITTINGS



PRODUCT CATALOGUE

**quba** GROUP™

[www.qubaindia.com](http://www.qubaindia.com)

# About quba GROUP

Our parent company is a well known name in the Indian architecture hardware industry. Established in 2010, it inherited a legacy in the hardware business combined with in-house manufacturing capabilities. The group is driven by good design and an emphasis on superior quality and distinctive aesthetics. It works with a varied range of individual retail customers, professionals and a variety of businesses. It strongly believes in a harmonious blend of technology and beauty - without compromises in either aspect - in order to be the best in the industry.

## The Quba Group Brands:



Architectural  
Hardware Fittings

Crafted with utmost passion and an eye for aesthetics, Quba brings to you a wide range of elegant, innovative and reliable security solutions.



Kitchen and Furniture  
Hardware Fittings

Unlock space in every corner with Symmetry. Smart and innovative kitchen and furniture fittings to make maximum out of your space and organise better.



Glass  
Hardware Fittings

Arteza's sophisticated and ultra-practical design language blended with superior engineering and good looks makes it a perfect fit to your home decor. Arteza collection ranges from designer architectural glass fittings to smart door control systems.



Inspiring  
bath Concepts

Beauty is made of details. Be it the contours, form or finish, Agua makes everyday bathing experience exquisite with the collection personifying elegance and minimalism design.



Quba is luxury hardware brand by the QUBA Group that embodies passion, individuality and authenticity. With a and inspires while staying sustainable in function and form.

Since it's inception in 2010, the brand has brought together and reined designs, exquisite craftsmanship and cutting edge technology to create pieces of art disguised as hardware. A true relection of bold and progressive ideals, QUBA is synonymous with modern luxury. The brand caters to people with a reined palate.

Experience excellence with QUBA's masterfully crafted collections that add a touch of grace with a whi of elegance to contemporary living spaces.

### CYLINDRICAL LOCK - KEY LESS

**MATERIAL** SS 304  
**FINISH** SS I AB

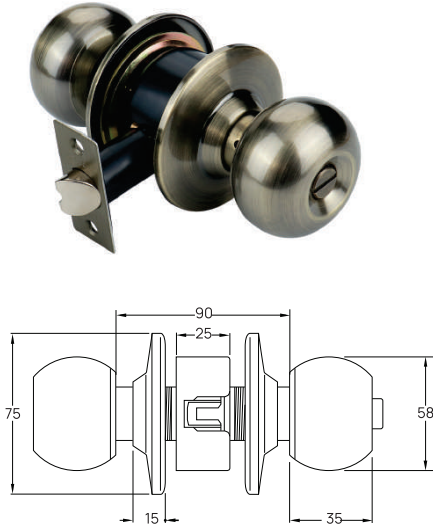

#### FEATURES

- Knobs made from high grade stainless steel
- Easy push-button facility for locking from inside
- Provision for emergency opening is provided from outside

### CYLINDRICAL LOCK - KEY LESS - ECO

**MATERIAL** SS  
**FINISH** SS

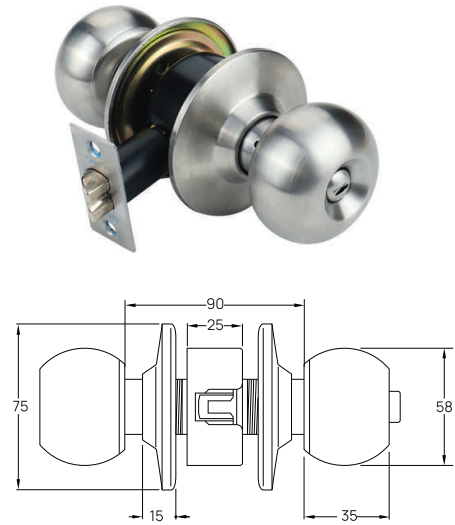

#### FEATURES

- Knobs made from high grade stainless steel
- Easy push-button facility for locking from inside
- Provision for emergency opening is provided from outside

### CYLINDRICAL LOCK - COMPUTER KEY

**MATERIAL** SS 304  
**FINISH** SS I AB

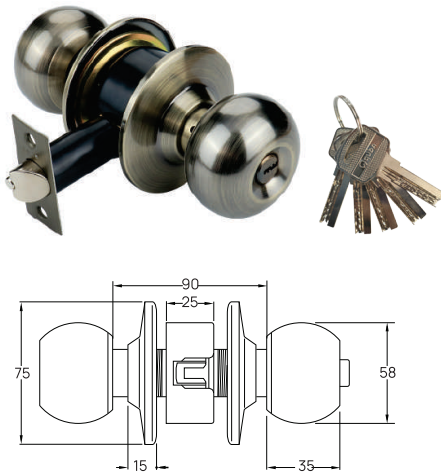

#### FEATURES

- Knobs made from high grade stainless steel
- Easy push-button facility for locking from inside
- Comes with Computer key
- Automatic deadlocking for extra safety

### CYLINDRICAL LOCK - REGULAR KEY - ECO

**MATERIAL** SS  
**FINISH** SS

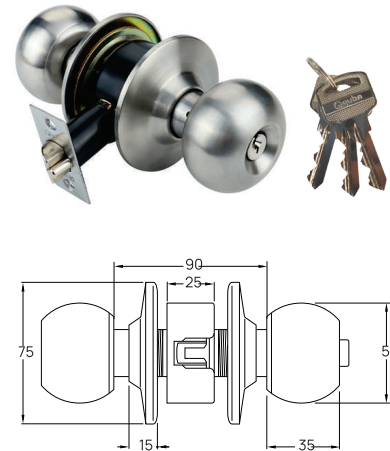

#### FEATURES

- Knobs made from high grade stainless steel
- Easy push-button facility for locking from inside
- Comes with regular key
- Automatic deadlocking for extra safety



## SAFE TOUCH CYLINDRICAL LOCK - KEY LESS

**MATERIAL** SS 304

**FINISH** SS | AB | RG | BN



### FEATURES

- Knobs made from high grade stainless steel
- Easy push-button facility for locking-unlocking from inside
- Provision for emergency opening is provided from outside
- Incorporated with Automatic Deadlocking for Extra Security
- Locking button facility for locking from Inside



Corrosion  
Resistance



Tested for 2 Lakhs  
Life Cycle

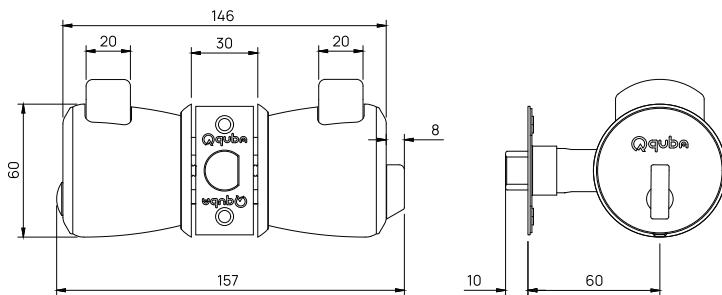

## SAFE TOUCH CYLINDRICAL LOCK - KEYED TYPE

**MATERIAL** SS 304

**FINISH** SS | AB | RG | BN



### FEATURES

- Knobs made from high grade stainless steel
- Easy push-button facility for locking-unlocking from inside
- Incorporated with Automatic Deadlocking for Extra Security
- Available in Dimple key & Regular Key
- Locking button facility for locking from Inside



Corrosion  
Resistance



Tested for 2 Lakhs  
Life Cycle

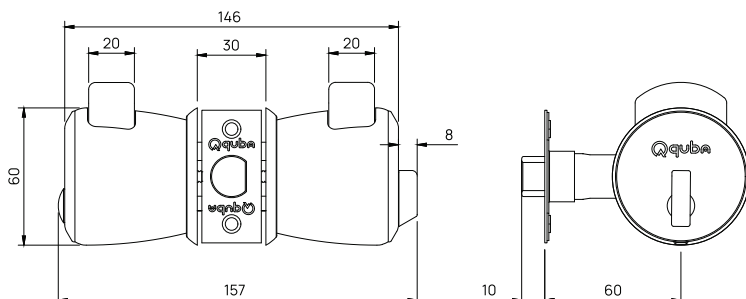

## CUPBOARD LOCK

FINISH SS | AB | RG | JBM | IV

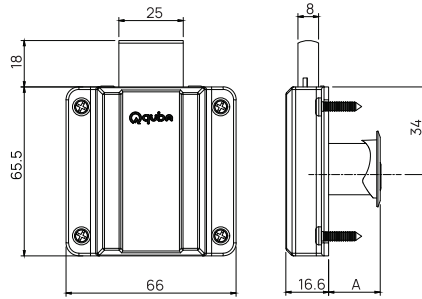

Dimension Chart

SR. NO.	CYL. SIZE	DIM "A"
1	25.00 mm	25.00
2	30.00 mm	30.00
3	35.00 mm	35.00

## FEATURES

- Precision Bolt Locking Mechanism
- Available in Dimple Key & Regular Key option.
- Also available with Common Key



## Model Q 203 D

## DRAWER LOCK

FINISH SS | AB | RG | JBM | IV

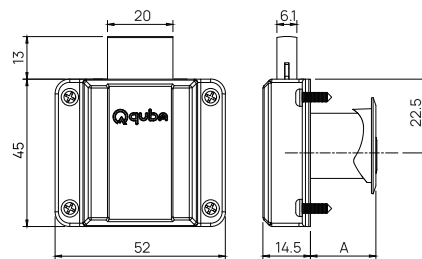

Dimension Chart

SR. NO.	CYL. SIZE	DIM "A"
1	25.00 mm	25.00
2	30.00 mm	30.00
3	35.00 mm	35.00

## FEATURES

- Precision Bolt Locking Mechanism
- Available in Dimple Key & Regular Key option.
- Also available with Common Key



## Model Q 203 CSL

## CENTER SLIDING LOCK

FINISH SS | AB | RG | JBM

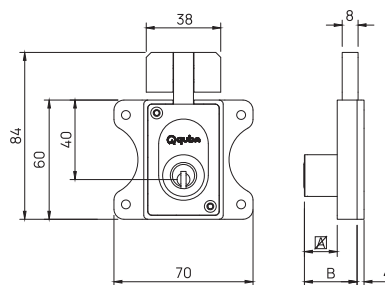
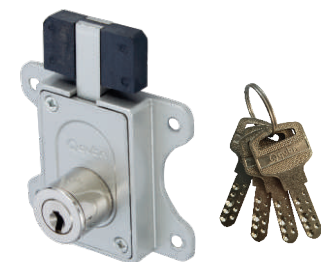

Dimension Chart

SR. NO.	CYL. SIZE	DIM "A"	DIM "B"
1	25.00 mm	17.00 mm	17.00 mm
2	30.00 mm	22.00 mm	22.00 mm

## FEATURES

- Precision Bolt Locking Mechanism
- Available in Dimple Key only



## SIDE SLIDING LOCK

FINISH SS | AB | RG | JBM

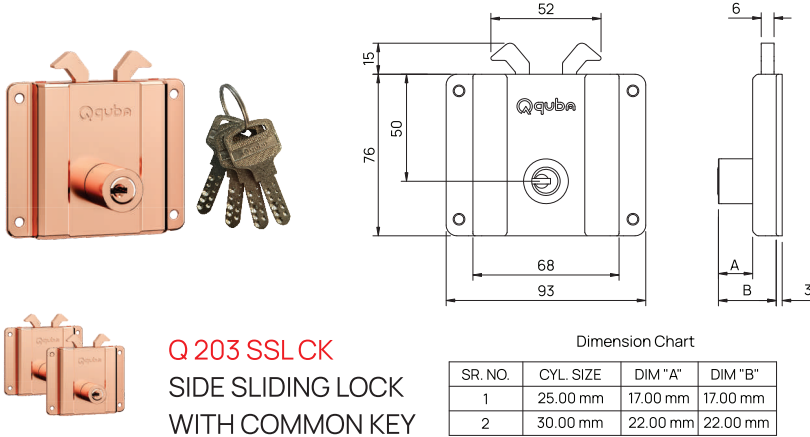

**Q 203 SSLCK**  
SIDE SLIDING LOCK  
WITH COMMON KEY

Dimension Chart

SR. NO.	CYL. SIZE	DIM "A"	DIM "B"
1	25.00 mm	17.00 mm	17.00 mm
2	30.00 mm	22.00 mm	22.00 mm

## FEATURES

- Precision Bolt Locking Mechanism
- Available in Dimple Key only
- Also available with Common Key
- Also available in Combo pack



Corrosion  
Resistance

Tested for 2 Lakhs  
Life Cycle

Hook Type  
Twin Deadbolts

Extra high  
Security

Model Q 203 V

## VERTEX LOCK

FINISH SS

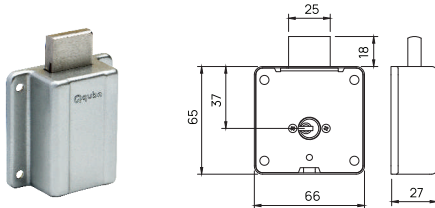

## FEATURES

- Precision Bolt Locking Mechanism
- Available in Dimple Key only



Corrosion  
Resistance

Tested for 2 Lakhs  
Life Cycle

Double Throw  
Precision Bolt

Extra high  
Security

Model Q UCL

## UNIVERSAL CUPBOARD LOCK

FINISH SS | AB

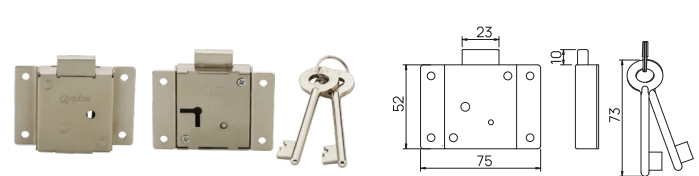

## FEATURES

- Precision 6 steel lever Locking Mechanism
- Four way mounting



Corrosion  
Resistance

Tested for 2 Lakhs  
Life Cycle

Model Q 200 M40

## MULTI LOCK - LASER KEY

FINISH SS

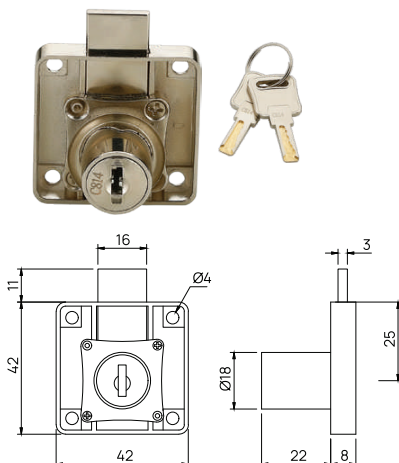

Model Q 200 M10E

## MULTI LOCK - REGULAR KEY (ECONOMY)

FINISH SS

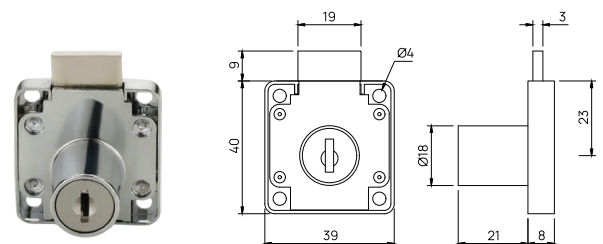

Dimension Chart

SR. NO.	CYL. SIZE	DIM "A"
1	20.00 mm	20.00
2	32.00 mm	32.00

## PUSH LOCK

FINISH SS

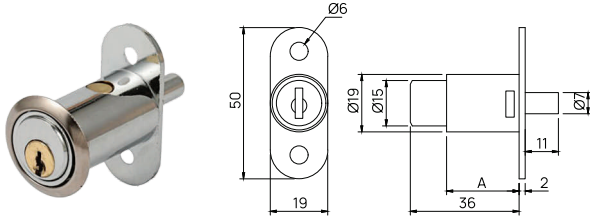

### FEATURES

- Push to lock & key required only to open.
- Ideal for locking overlay shutters and sliding cabinet shutters.



Corrosion Resistance

Dimension Chart

SR. NO.	CYL. SIZE	DIM "A"
1	25.00 mm	25.00
2	32.00 mm	32.00

## SLIDING DOOR LOCK

FINISH SS

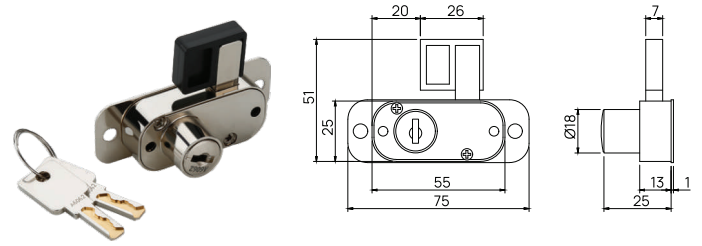

### FEATURES

- Precision Bolt Locking Mechanism
- Available in Laser Key



Corrosion Resistance



Single Lock For Overlapped shutter



Extra high Security

## SLIDING DOOR LOCK (SIDE MOUNTED)

FINISH SS

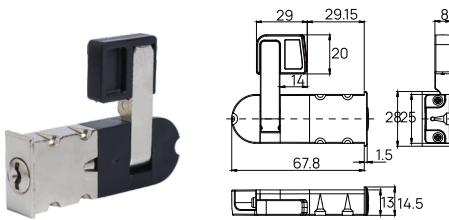

### FEATURES

- Precision 6 steel lever Locking Mechanism
- Four way mounting



Corrosion Resistance



Single Lock For Overlapped shutter

## PEDESTRIAL LOCK

FINISH SS

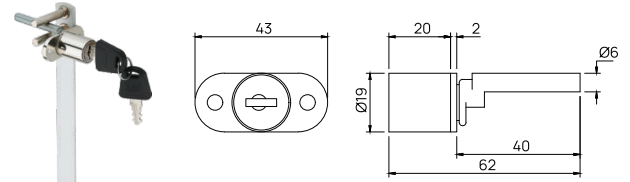

### FEATURES

- Available in 480mm & 580mm
- Key Removable in locked & unlocked positions
- 180degree rotary lifting pin movement
- Easy press fit due to built-in spring clip



Corrosion Resistance

## 90 MM SECURA DISC PAD LOCK

MATERIAL SS 304

FINISH SS

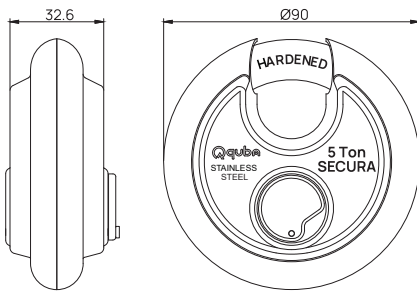

## FEATURES

- Full welded, Weather tough, Rust resistant body
- Anti Burglary Sturdy Design
- Narrow Throat to prevent Crowbar entry
- Hacksaw resistant, Hardened Electroplated Shackle
- SS Weather Cap Prevents Entry of dust
- Brass cylinder for durability
- Dimple Key Technology cylinder provides extra security with 10 pins makes the lock unpickable, with over 1 million combination



Q 690 DU - COMBO PACK WITH COMMON KEY

## 70MM SECURA DISC PAD LOCK

MATERIAL SS 304

FINISH SS

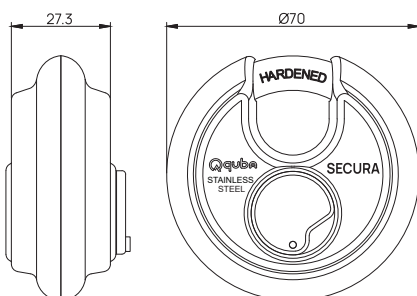

## FEATURES

- Full welded, Weather tough, Rust resistant body
- Anti Burglary Sturdy Design
- Narrow Throat to prevent Crowbar entry
- Hacksaw resistant, Hardened Electroplated Shackle
- SS Weather Cap Prevents Entry of dust
- Brass cylinder for durability
- Dimple Key Technology cylinder provides extra security with 10 pins makes the lock unpickable, with over 1 million combination



Q 670 DU - COMBO PACK WITH COMMON KEY

MATERIAL SS 304  
FINISH SS

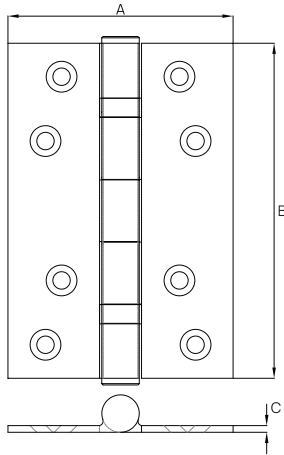

Dimension Chart

A	B	C
3"	2.5"	2.5MM
4"	3"	2.5MM
5"	3"	2.5MM
4"	3"	3MM
5"	3"	3MM

Model BUTT HINGES

MATERIAL SS 202 & SS 304  
FINISH SS

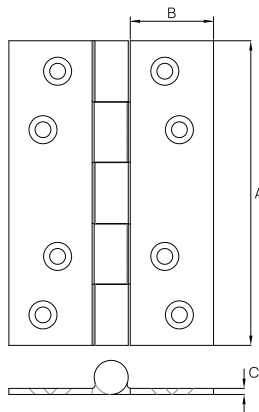

Dimension Chart

A	B	C
3"	1"	2.5MM
4"	1"	2.5MM
5"	1"	2.5MM
4"	1.25"	3MM
5"	1.25"	3MM
6"	1.25"	3MM
3"	1"	1.7MM
3"	1"	1.9MM
4"	1"	1.9MM
5"	1.25"	1.9MM
6"	1"	2.5MM

Model RAILWAY HINGES

MATERIAL BRASS  
FINISH SS I AB

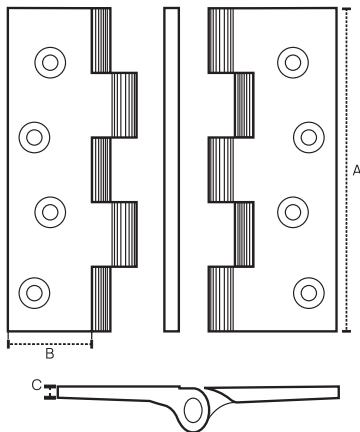

Dimension Chart

A	B	C
125MM	25MM	3MM
125MM	28MM	3MM
125MM	28MM	4MM
125MM	31MM	4MM

ABBREVIATION	FULL FORM
SS	Satin Steel
SSM	Satin Steel Matt
SS/CP	Satin Steel/Chrome Plates
AB	Antique Brass
ABM	Antique Brass Matt
RG	Rose Gold
RGPVD	Rose Gold Physical Vapor Deposition
RGMPVD	Rose Gold Matt Physical Vapor Deposition
BMPVD	Black Matt Physical Vapor Deposition
GPVD	Gold Physical Vapor Deposition
GP	Gold Plated
BM	Black Matt
JBM	Jet Black Matt
MB	Milango Beige
TB	Terra Bronze
W	Wooden
WH	White
CK	Common Key
MK	Master Key





## Architectural Hardware Fittings

Crafted with utmost passion and an eye for aesthetics, Quba brings to you a wide range of elegant, innovative and reliable security solutions.



## SYMETRY® BY QUBA GROUP

## Kitchen and Furniture Hardware Fittings

Unlock space in every corner with Symmetry. Smart and innovative kitchen and furniture fittings to make maximum out of your space and organise better.



## Glass Hardware Fittings

Arteza's sophisticated and ultra-practical design language blended with superior engineering and good looks makes it a perfect fit to your home decor. Arteza collection ranges from designer architectural glass fittings to smart door control systems.



## Inspiring bath Concepts

Beauty is made of details. Be it the contours, form or finish, Agua makes everyday bathing experience exquisite with the collection personifying elegance and minimalism design.